

ST201 Spacer Tube

Durable Spacer for New Water Line Installations



The [NextCentury Spacer Tube \(ST201\)](#) uses a simple but versatile design to be used prior to the installation of any standard 7.5" long meter. The ST201 is made to comfortably handle significant temperatures and pressures, eliminating concerns related to spacer tube durability.

Spacer Tube Basics

Spacer tubes are recommended for new plumbing installations. Debris commonly found in water supply lines during installation can potentially obstruct a water meter's flow chamber, hindering its functionality and damaging the meter. The use of a spacer tube facilitates water line flushing after installation.

Specifications

- 1" diameter x 7.5" length
- Made out of PA66 + 33% GF
- Maximum working temperature is 194°F
- Maximum working pressure is 150 PSI
- NSF/ANSI 61 & 372 Certified

Dimensions

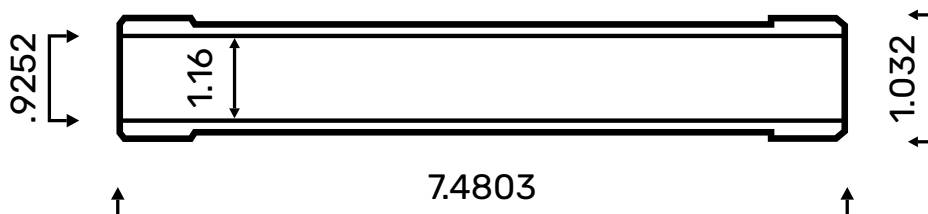

Side View

All measurements in inches